



au-Lika
Designed & Made in Italy



Saeco Aulika

The Aulika is the latest addition to Saeco's professional coffee machine range specifically designed for office use. Innovative, functional and easy to use, the Aulika delivers the perfect cup of coffee while retaining the speediness and practicality of a fully automatic office coffee machine.

At the pinnacle of Saeco's technological innovation, the Aulika has the capacity of delivering Espresso, Cappuccino, and Latte and more at a rate of 130 cups per hour, making this coffee machine ideal for medium to large offices, while never losing on taste and texture.

As for practicality, the machine features a one-touch function where both coffee and milk are integrated into the same pouring group. The new Cappuccinatore (frother) system, baptized by Saeco as the "Pinless Wonder", not only delivers the perfectly steamed milk that is hot and consistent in temperature, but is also very easy to clean – a function integrated in the machine which prompts the user on how to / when to perform the cleaning cycle.

The Aulika also comes standard with a hot water / steam wand and a spacious 4L water tank complete with filtration unit. If required, the machine may also be "hard plumbed" through the application of a "plumb-in kit". The combination of its water tank capacity and 1kg bean hopper allows the Aulika to produce 100+ cups without having to refill, and a generous waste drawer is fitted to match.

auLika

auLika

 Saeco

The Aulika is operated through a user-friendly keypad with an easy to read and clear LCD display. Effortless menu navigation coupled with exclusive options in the "star menu" makes this coffee machine extremely versatile with the ability to satisfy all palates at the touch of a button.

The Aulika doesn't just make great tasting coffees; it also features a stunning modern design with its stainless steel finish. All these features are packed in a compact package which won't take much of your valuable office space.



auLika

auLika

Saeco

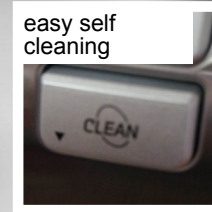
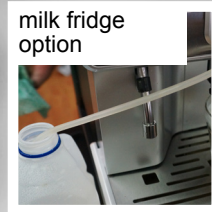
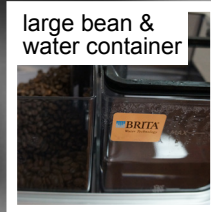
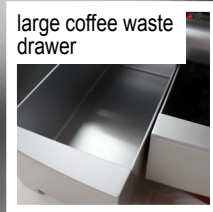
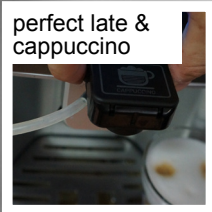

Technical data Aulika	Electrical characteristics	Water connections	Water tank capacity 4 l	Coffee dose adjustment •
Structural characteristics	Power supply 230-240/50 Hz - (120-220V/60 Hz)	Water supply connection 3/4"	Grounds drawer capacity 40	Automatic Cappuccinatore •
Dimensions (w x h x d) 334 x 574 x 452 mm	Absorbed power 1400W	Water supply plumbed in or with autonomous tank	Coffee grinder with steel conical grinding blades •	Digital display 5"
Weight 22 kg (23 kg - water net connection version)	Hydraulic characteristics	Other characteristics	Removable coffee group from 6 gr to 10 gr	Automatic decalcification cycle •
Frame material metal	Boiler 2	Performance 1	Height-adjustable coffee dispenser •	Simultaneous delivery of 2 coffee cups •
Chassis material ABS	Boiler material stainless steel	Water tank 1	Grind adjustment •	Number of selections 5
Water tank removable	Swivel water/steam spout •	Coffee beans container capacity 1 kg	Electronic preinfusion •	Number of pre-selections 1

auLika

Saeco