

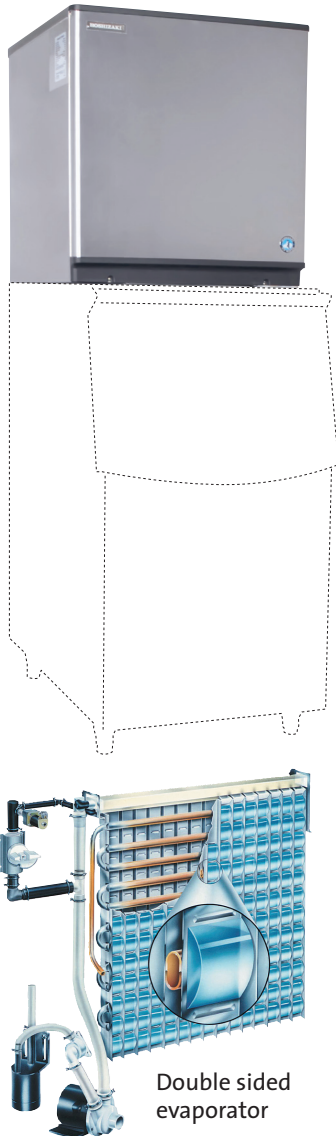

HOSHIZAKI



KMD-201AA/AWA CRESCENT ICE MAKERS



Double sided evaporator

Product Description

The KMD-201AA (air cooled) and KMD-201AWA (water cooled) are modular ice makers which produce clear, crescent shaped cubes.

- Versatile ice shape used in diverse applications such as splash-free serving of post mix soft drinks, fish transportation, display and even laser therapy.
- Individual premium crescent cube with no ice bridging.
- Exceptionally hard crystal clear cubes that melt slowly.
- CycleSaver® design allows KM machines to produce more ice, using less energy, while cycling 1/2 as many times as the competition.
- Includes a double-sided stainless steel evaporator, which requires fewer cycles to produce a full bin of ice, thereby reducing energy consumption.
- Slide in air filter for easy cleaning - maintaining performance efficiency (air-cooled only).
- Cold and wet areas are insulated and separated from electrical and heat producing components. These design features improve the reliability, sanitation and reduce maintenance and service cost.

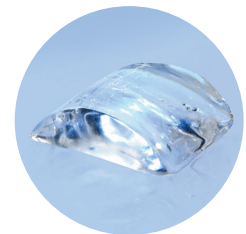
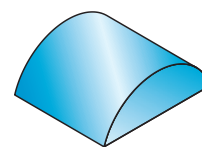

Ice Type: Crescent
Size: 30 x 37 x 13 mm

Available Models

Model	Air Cooled	Water Cooled
KMD-201AA	•	
KMD-201AWA		•

Bins

Model	Corresponding Bins
KMD-201AA - Modular Type	B-801SA
KMD-201AWA - Modular Type	B-801SA

Production

Model	Ice Production per 24h (Approx.)			Temperature	Ice Production per Cycle (Approx.)	Water Consumption per 24h (Approx.)		
KMD-201AA	190 / 205kg	167 / 182kg	135 / 157kg	AT.10°C, WT.10°C	3.8 / 3.8kg / 416pcs	0.90 / 0.98m ³	0.40 / 0.48m ³	0.27 / 0.31m ³
				AT.21°C, WT.15°C				
KMD-201AWA	190 / 208kg	170 / 192kg	155 / 175kg	AT.32°C, WT.21°C	3.9 / 4.0kg / 416pcs	0.43 / 0.51m ³	0.32 / 0.36m ³	0.30 / 0.33m ³

For more information visit our website
www.hoshizaki-europe.com

Hoshizaki Europe B.V. retains the right to change products and their specifications without prior notice.





HOSHIZAKI

KMD-201AA/AWA CRESCENT ICE MAKERS

KMD-201AA

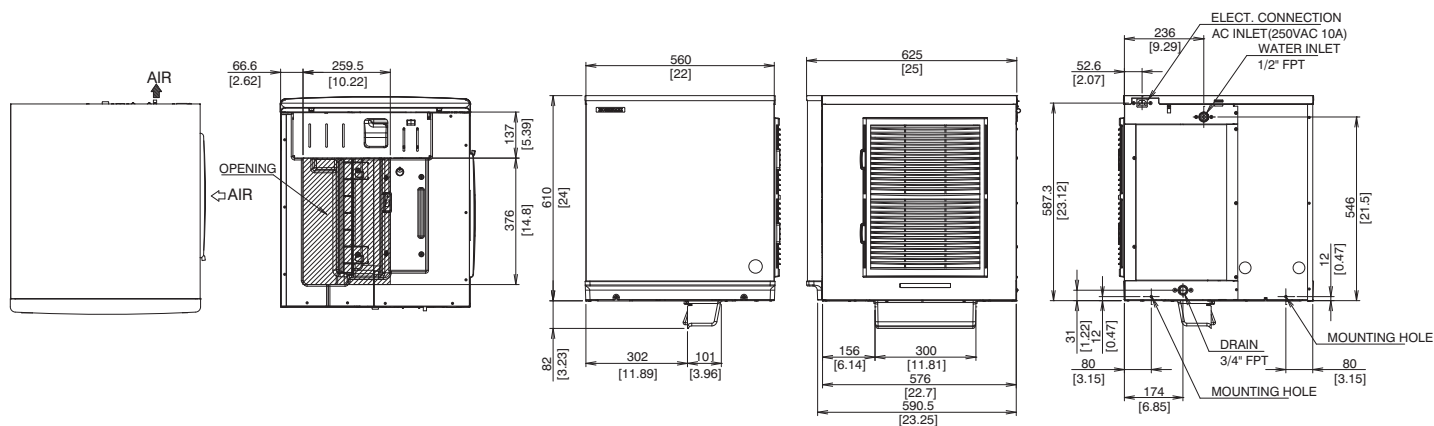

KMD-201AWA

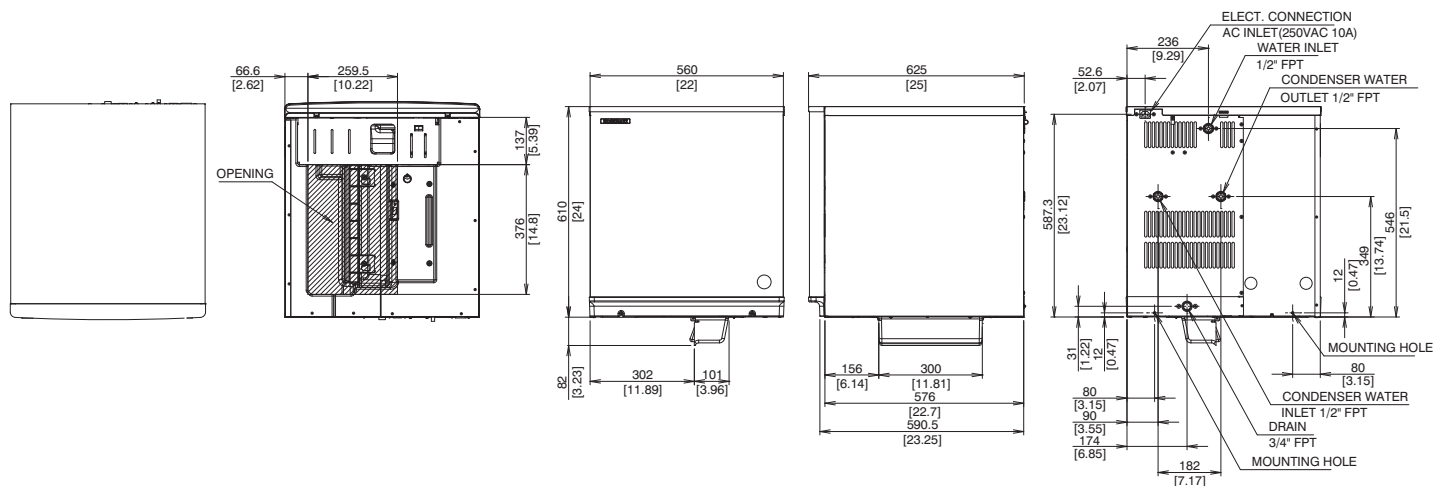

Specifications

Specification	KMD-201AA	KMD-201AWA
AC Supply Voltage	1 Phase 220 - 240 / 230V, 50 / 60Hz	
Electric Consumption (AT.32°C, WT.21°C)	700 / 810W	589 / 758W
Insulation Foam Blowing Agent	Cyclopentane/CFC Free/ODP:0/GWP:3	
Heat Rejection (AT.32°C, WT.21°C)	1410W	-
Refrigerant Charge	R404A	R404A

Full CAD specification drawings available on website

Operation Requirements
Ambient Temperature: 7 - 40°C
Water Supply Temperature: 7 - 35°C
Water Supply Pressure: 0,7 - 7,8 bar (0,07 - 0,78MPa)
Voltage Range: 198 - 254V
Accessories
Instruction Manual, Universal Brace, Bolt(2) Power Cord-SE type plug(-C1 01), BF type plug(-C111), o type plug(-C121), B3 type plug(-C131), A(angled) type plug(-C141), A(parallel) type plug(-C151)

For more information please contact your local sales office:

Hoshizaki Belgium:
Hoshizaki Deutschland:
Hoshizaki France:
Hoshizaki Iberia:
Hoshizaki Middle East:

info@hoshizaki.be
info@hoshizaki.de
info@hoshizaki.fr
info@hoshizaki.es
info@hoshizaki.ae

Hoshizaki Nederland:
Hoshizaki United Kingdom:
Other countries:

sales@hoshizaki.nl
uksales@hoshizaki.co.uk
sales@hoshizaki.nl

www.hoshizaki-europe.com